

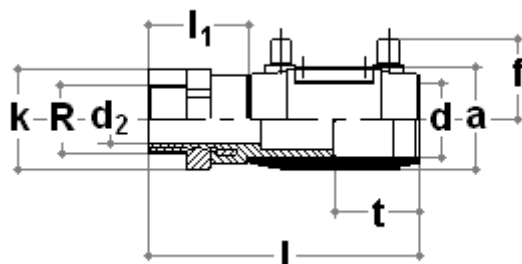

**Manicotto passaggio elettrico PE 100**  
Attacco filettato maschio in acciaio o ottone

**PE 100 electric coupler**  
Steel or brass male threaded injection moulded



<b>Dimensioni</b> <i>Dimension</i>	<b>Dettagli</b> <i>Detail</i>	<b>d</b> (mm)	<b>R</b> (inch)	<b>l</b> (mm)	<b>l<sub>1</sub></b> (mm)	<b>a</b> (mm)	<b>f</b> (mm)	<b>d<sub>2</sub></b> (mm)	<b>K</b> (mm)	<b>t</b> (mm)	<b>Peso</b> <i>Weight</i> (Kg)
20 x 1/2"	SDR 11	20	1/2"	120	45	30	34	12,0	32	37	0,01
25 x 3/4"	SDR 11	25	3/4"	127	46	35	37	16,0	36	40	0,17
32 x 1"	SDR 11	32	1"	138	49	42	40	21,0	41	44	0,23
40 x 1 1/4"	SDR 17/11	40	1 1/4"	151	52	53	44	27,5	50	49	0,34
50 x 1 1/2"	SDR 17/11	50	1 1/2"	166	55	67	49	33,5	60	55	0,51
63 x 2"	SDR 17/11	63	2"	189	62	83	56	42,0	70	63	0,80

Gas S8 – S5  
Acqua PN 10, 16, 25  
PE 100 nero

*Gas S8 – S5*  
*Water PN 10, 16, 25*  
*PE 100 black*