



Bocchettone PP-H

- Codice prodotto: BBM
- Estremità per saldatura testa a testa
- Attacchi in accordo con le seguenti norme:
DIN 16962, accoppiabili con tubi secondo le norme EN ISO 15494, DIN 8077-8078, UNI 8318.

PP-H 90° socket union

- Product code: BBM
- Ends for butt fusion welding
- Coupling according with following standards:
DIN 16962, coupling to pipes complying with EN ISO 15494,
DIN 8077-8078, UNI 8318.

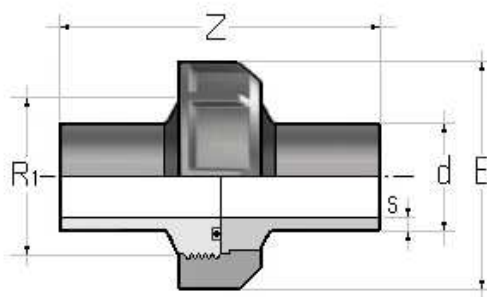

| d | PN | Z | R ₁ | E | SDR 11 - S 5 - PN 10 | |
|----|----|-----|----------------|-----|----------------------|-----------------|
| | | | | | s | Peso Weight (g) |
| 20 | 10 | 190 | 1" | 46 | 1,9 | 70 |
| 25 | 10 | 190 | 1¼" | 56 | 2,3 | 105 |
| 32 | 10 | 190 | 1½" | 66 | 2,9 | 140 |
| 40 | 10 | 190 | 2" | 79 | 3,7 | 210 |
| 50 | 10 | 190 | 2¼" | 87 | 4,6 | 295 |
| 63 | 10 | 190 | 2¾" | 107 | 5,8 | 480 |