



Collare d'appoggio PE-HD

- Codice prodotto: DQIE
- Materiale: PE-HD 100, SDR 11, PN 16
- Colore: Nero
- Estremità femmina per saldatura a tasca



HD-PE stub flange

- *Product code: DQIE*
- *Material: HD-PE100, SDR 11, PN 16*
- *Color: Black*
- *Female sockets fusion welding*

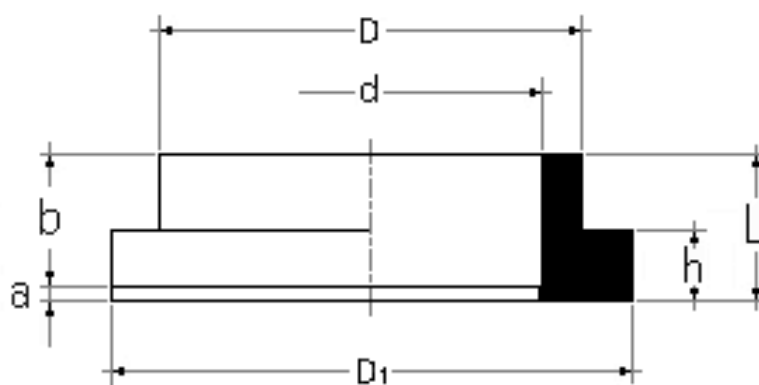

d (mm)	PN (bar)	D (mm)	D ₁ (mm)	L (mm)	a (mm)	b (mm)	Peso Weight (Kg)
20	16	27,0±1,0	45,0 ±1,0	19,0±1,5	5,0±1,0	14,5±1,0	0,15
25	16	33,0±1,0	58,0 ±1,0	21,0±1,5	5,0±1,0	16,0±1,0	0,20
32	16	41,0±1,0	68,0 ±1,0	25,0±1,5	6,0±1,0	19,0±1,0	0,24
40	16	50,0±1,0	78,0 ±1,0	26,5±1,5	4,0±1,0	22,5±1,0	0,40
50	16	61,0±1,0	88,0 ±1,0	29,0±1,5	5,5±1,0	23,5±1,0	0,50
63	16	76,0±1,0	102,0±1,0	33,5±1,5	5,0±1,0	28,5±1,0	0,60
75	16	91,0±1,0	122,0±1,0	38,0±1,5	7,5±1,0	30,5±1,0	0,70
90	16	109,0±1,0	138,0±1,0	42,0±1,5	6,5±1,0	35,5±1,0	0,80
110	16	131,0±1,0	158,0±1,0	46,5±1,5	5,0±1,0	41,5±1,0	1,00