



**Flangia libera PP con anima metallica
Standard ANSI 150**

Colore: Nero (o beige)
Codice: DODBA



**PP backing ring with steel core
ANSI 150 standard**

Color: Black (or beige)
Code: DODBA

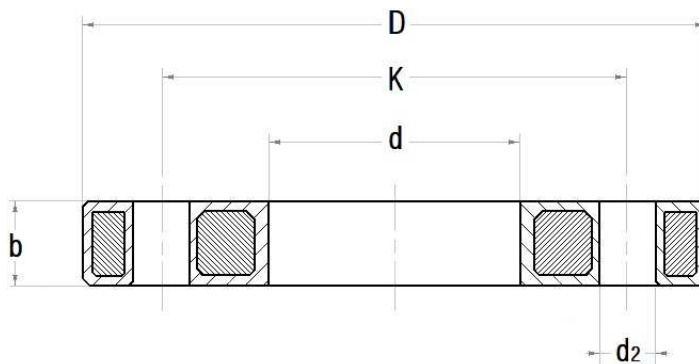

d	Inch	d	D	K	d ₂	b	Viti Screws (nr.)	Viti Screws (inch)	Peso Weight (Kg)
20	1/2"	28	95	60,4	16,0	12	4	1/2"	0,22
25	3/4"	34	102	69,7	16,0	12	4	1/2"	0,24
32	1"	42	114	79,2	16,0	16	4	1/2"	0,39
40	1 1/4"	51	130	88,7	16,0	16	4	1/2"	0,53
50	1 1/2"	62	133	98,3	16,0	18	4	1/2"	0,56
63	2"	78	162	120,0	20,0	18	4	5/8"	0,84
75	2 1/2"	92	181	139,7	20,0	18	4	5/8"	1,07
90	3"	111	194	152,4	20,0	18	4	5/8"	1,10
110	4"	133	229	190,6	20,0	18	8	5/8"	1,57
160	6"	178	283	241,2	23,0	24	8	3/4"	2,35
200	8"	236	345	298,2	23,0	24	8	3/4"	3,39
250	10"	288	412	360,9	26,0	27	12	7/8"	6,20
315	12"	338	487	431,2	26,0	32	12	7/8"	12,60