



## Bussola riduzione PP

- Codice prodotto: DDFM
- Estremità maschio filettata (R<sub>1</sub> di riferimento) ed estremità femmina filettata (R ridotto)
- Colore: Beige RAL 7032
- Giunzione: Filettatura cilindrica secondo UNI ISO 228/1
- Dimensioni: Ø ¼" ÷ Ø 2"
- Temperature di esercizio: - 10°C ÷ +100 °C
- Pressione di esercizio max: 10 bar

## PP reducing bush

- Product code: DDFM
- Male parallel threaded (G<sub>1</sub> of reference) socket parallel threaded (G reduced)
- Color: Beige RAL 7032
- Joint: Gas parallel threaded standards UNI ISO 228/1
- Dimensions: Ø ¼" ÷ Ø 2"
- Working temperature: - 10°C ÷ +100 °C
- Max working pressure: 10 bar

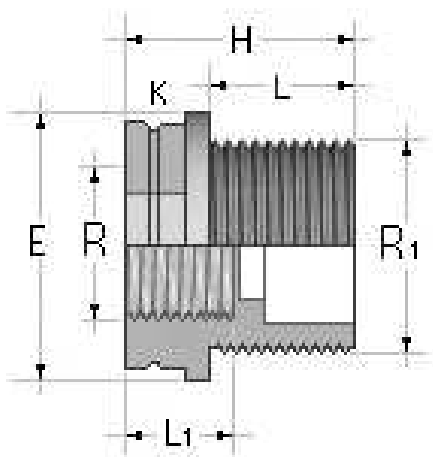

R <sub>1</sub> x R (inch)	L (mm)	L <sub>1</sub> (mm)	H (mm)	E (mm)	K (mm)
¾" x ¼"	10,0	10,0	20,0	20,0	17,0
½" x ⅜"	16,0	15,0	26,5	28,0	25,0
¾" x ⅜"	18,0	14,0	33,0	30,5	27,0
¾" x ½"	18,0	17,0	33,0	31,0	27,0
1" x ½"	19,5	17,0	35,0	41,0	36,0
1" x ¾"	19,5	19,0	35,0	41,0	36,0
1¼" x ½"	21,0	15,0	39,0	49,5	46,0
1¼" x ¾"	21,0	16,0	39,0	49,5	46,0
1¼" x 1"	21,0	19,0	39,0	49,5	46,0
1 ½" x ¾"	21,0	16,0	39,0	54,0	50,0
1½" x 1"	21,0	21,0	39,0	54,0	50,0
1½" x 1¼"	21,0	29,0	39,0	54,0	50,0
2" x 1"	25,5	19,0	43,5	69,0	65,0
2" x 1¼"	25,5	21,0	43,5	69,0	65,0
2" x 1½"	25,5	21,0	43,5	69,0	65,0